

AVAILABLE IMMEDIATELY

76,985 & 6,037 RSF
**AVAILABLE
FOR LEASE**

1401 Crooks Road
Troy, MI, 48084

In The Heart Of Troy

1401 Crooks Offers A Spectacular Location
For Forward Thinking Businesses To Grow And Expand

Easy Access To I-75 And Big Beaver Road's Shops and Restaurants

1401 CROOKS
— TROY —



Josh Suardini
Vice President

248-358-0800
jsuardini@etkinllc.com
etkinllc.com



OAKLAND/TROY AIRPORT VLL

HELLER

WAL★MART
SUPERCENTER

HOMWOOD
SUITES by Hilton

MERITOR
RUN WITH THE BULL

CAFE SUSHI
RENEE'S GOURMET
PIZZERIA
SUBWAY

FISHER
DYNAMICS

APOVINI GRILL

NATIONAL
CONEY ISLAND
SINCE 1955

OSAKA

creativesolutionsgroup
tradeshows • events • multimedia

GLG
GLOBAL LOGISTICS GROUP

MAPLE ROAD

CROOKS ROAD

W. Big Beaver Road

Crooks Road

Maple Road

1401
CROOKS

1401 Crooks Road
Troy, MI 48084

One-story office/industrial
facility with easy access to
I-75 Freeway.

76,985 & 6,037 RSF OF SPACE

ETKIN
REAL ESTATE / SOLUTIONS

Josh Suardini
Vice President

248-358-0800
jsuardini@etkinllc.com

etkinllc.com

1401 CROOKS
— TROY —

BUILDING FEATURES & AMENITIES

- One-story office/industrial facility, separate storage flex facility available
- The building is constructed of brick veneer, glass and block and has ample parking
- Large, open work areas with multiple windowed offices possible
- Flexible floor plan to allow for lab and research
- Landscaped grounds and professionally managed and maintained
- Easy access to I-75 expressway and close proximity to restaurants, hotels and retail areas on Crooks, Maple, Coolidge and Big Beaver Roads
- Separate customer and staff entries exist if needed
- Executive wing is available and includes private restrooms, spacious conference area and board room for higher level meetings.



1401 CROOKS
— TROY —



Josh Suardini
Vice President

248-358-0800
jsuardini@etkinllc.com
etkinllc.com

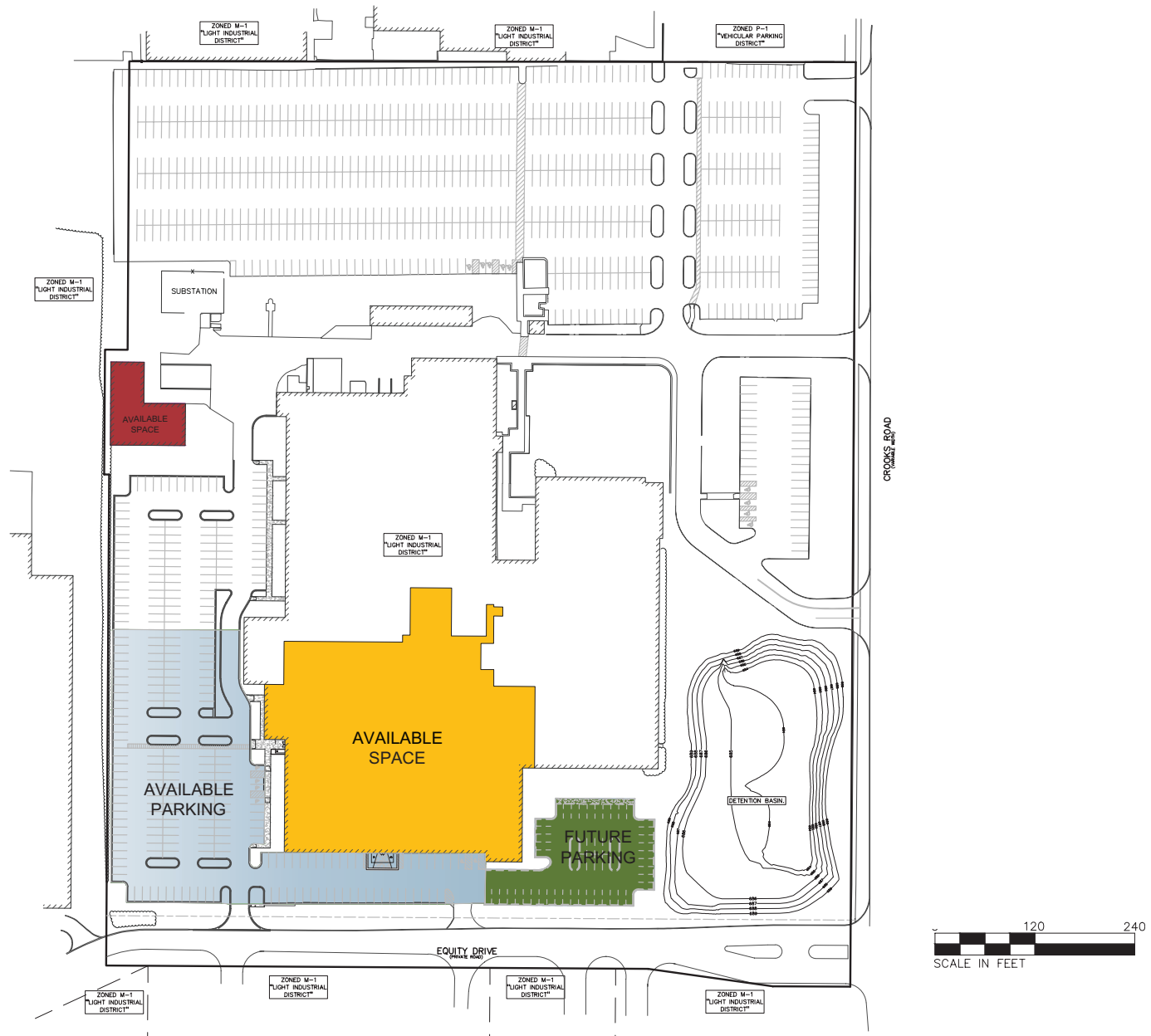

1401 CROOKS
— TROY —



Josh Suardini
Vice President

248-358-0800
jsuardini@etkinllc.com

etkinllc.com

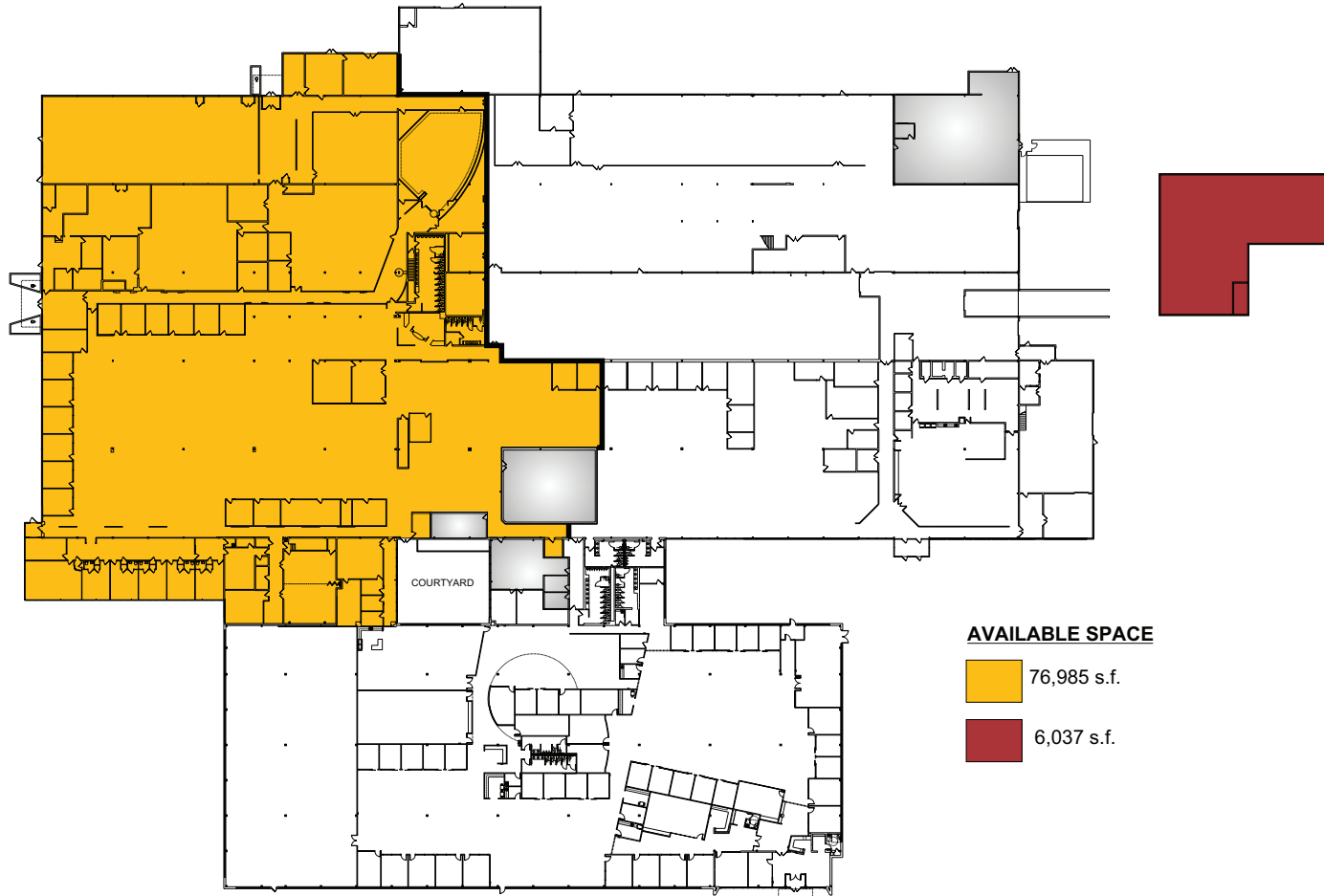

Available
76,985 RSF
and 6,037 RSF

- Flexible floor layouts
- Market tenant improvements available

1401 CROOKS
— TROY —



Josh Suardini
Vice President

248-358-0800
jsuardini@etkinllc.com
etkinllc.com